



## Thermal Bridging Solution

Designed to prevent cold bridging primarily on returned reveals around both windows and door openings.

- Helps to meet building regulations on brick to block or block to block and timber or steel frame buildings.
- The foam is bonded to a DPC (drainage and protection course), which helps to prevent moisture from penetrating the wall.
- Bonded to a DPC which meets BS6515:84 to meet test method BS20782, 720A, 620A, 620B and 620D compliant with building regulations.
- Foam tolerance is +/-2mm as it is packed under com
- The product is easy to install and can be used in a variety of applications.



# FOAM CAVITY BRIDGE

Thermal Bridging Solution for construction applications

## Technical Data



### FIRE

The polyethylene foam used is manufactured to ISO 1923, 845, 1926, 844, 1856-B with FMUSSNR 302 flammability test certificate and meets DIN53428 to building regulations.



### THERMAL

GIS Lamella Mat meets NHBC requirements for thermal bridging of return reveals.



### INSTALLATION

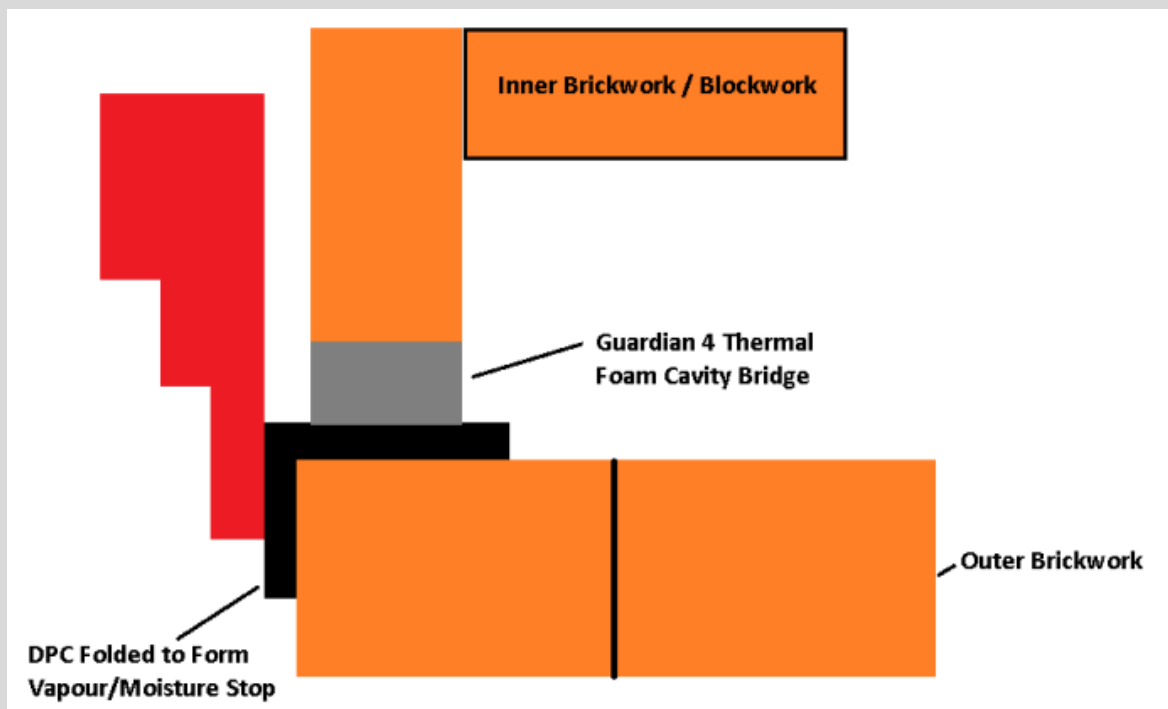

# FOAM CAVITY BRIDGE

Thermal Bridging Solution for construction applications

## Technical Data

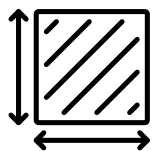

### PRODUCT DETAILS

Order reference	Product Dimensions (mm)	DPC Width	Roll Length (m)	Rolls per pack
GTH/100/10/165	100 x 10	165	6	10
GTH/100/10/225	140 x 10	225	6	7
GTH/100/10/337	215 x 10	337	6	5
GTH/100/20/165	100 x 20	165	6	6
GTH/100/20/225	140 x 20	225	6	6
GTH/100/20/337	215 x 20	337	6	5
GTH/100/30/165	100 x 30	165	6	5
GTH/100/30/225	140 x 30	225	6	5
GTH/100/30/337	215 x 30	337	6	4